

POTTING BOXES

100 Series Open Potting Boxes

Comprehensive range of open top potting boxes.
Maximum protection against shock, chemicals, moisture and temperature.

- Encapsulate and protect electronic components
- Moulded in ABS
- Highly resistant to most chemicals
- High rigidity and impact strength
- Compliant with water absorption specifications to DIN53495

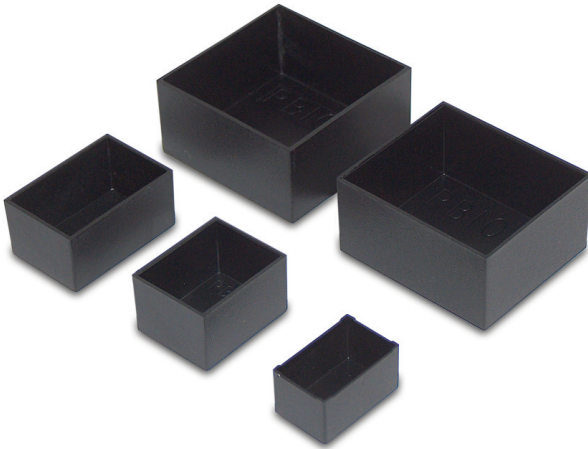

SPECIFICATION

Materials	ABS, UL94-V0 to order
Operating temperature	-20°C to +94°C
Standard colours	Black
Standard unit includes	Box Packs of 10

BLACK	LENGTH	WIDTH	HEIGHT	WALL THICKNESS
RTM101-BLK	25mm	20mm	15mm	1mm
RTM102-BLK	30mm	20mm	15mm	1mm
RTM103-BLK	40mm	35mm	20mm	1mm
RTM104-BLK	50mm	40mm	30mm	1mm
RTM105-BLK	75mm	50mm	35mm	1.4mm
RTM106-BLK	100mm	60mm	25mm	1.5mm
RTM107-BLK	40mm	40mm	20mm	1mm
RTM108-BLK	50mm	50mm	30mm	1mm
RTM109-BLK	11mm	11mm	9mm	0.5mm
RTM110-BLK	22mm	14mm	9mm	0.5mm
RTM111-BLK	30mm	30mm	20mm	1mm
RTM112-BLK	25mm	25mm	25mm	1mm
RTM113-BLK	40mm	40mm	30mm	1mm
RTM114-BLK	75mm	75mm	40mm	1mm
RTM115-BLK	89mm	64mm	33mm	1.5mm
RTM116-BLK	100mm	50mm	25mm	1.3mm

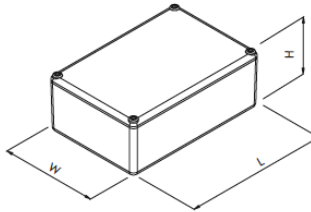

UNIVERSAL ENCLOSURES

HAND HELD CASES

HEAVY DUTY ENCLOSURES

DIN RAIL BOXES

INTERFACE SUPPORTS

CONTROL STATIONS

DIECAST & METAL BOXES

DESKTOP & INSTRUMENT CASES

POTTING BOXES

19" ENCLOSURES

19" CABINETS

DEVELOPMENT BOARDS

CUSTOM SIZED ENCLOSURES

CUSTOM SERVICES