

Young500

Bedienungsanleitung

user manual



Security instructions	22
Product information	
Features/Delivery content	24
Name of each part	25
Name of displayed features.....	26
Starting operation	
Install belt clip	27
Replace the batteries.....	27
Recharge batteries.....	27
Check battery condition	28
External earset.....	28
Turn the radio on.....	27
Turn the radio off.....	27
General operation	
General	29
Transmitting.....	30
Channel selection	30
CTCSS code	30
VOX / Hands-Free Operation	31
Transmitting VOX / Hands-Free	31
Call-Ring tone	32
Rogerbeep	32
Key tone	32
Receiving	33
Volume control	33
Monitor function	33
Channel scan.....	33
key lock	34
Dual Watch.....	34
Power Hi/Low.....	35
Out of range function.....	35
Indications for the application.....	36
Specification/CTCSS Table	37
Declaration of Conformity	38
Warranty regulations	39

Security instructions



Please read this information carefully before you use the two way radio.

General instructions

- Don't use the unit while driving a car or riding a bike.
- Don't place the unit on unstable location, if it falls down, people may be injured.
- The unit is not a toy, please beware of small children.
- If you connect the unit to other electronic devices, please study also the security instruction of this device.
- If you have any question regarding the unit, how it works, the safety or the correct connection please contact our technical support or ask any specialist.
- The seller will not be liable for any damages caused by misuse of the product and any claim from third parties.
- The rubber buttons at the bottom of the charger contains softener and may leave stains on furniture surfaces, so please, avoid direct contact.

Environmental conditions

- Don't leave the product close to magnetic cards like credit cards. The magnet of the loudspeaker can damage the information on this card.
- Don't drop or shake the unit, it might be damaged.
- Avoid too high pressure to the LC-display, it might be damaged.
- Don't leave the unit where the temperature is higher than 60°C, e.g. in cars with closed windows in the summertime, near heaters or any other type of heat source.
- Don't use the unit in rooms with high humidity e.g. bathrooms.
- Don't use the unit at dusty places.
- If you use the unit close to electromagnetic fields or mobile phones,

unwanted noise could be recorded.

- If you connect the unit to other electronic devices, please study also the security instruction of this device.

Batteries

- Don't leave empty batteries in the unit.
- Don't try to recharge Alkaline batteries.
- Batteries can be extremely dangerous if accidentally swallowed. Therefore keep the unit out of reach of small children.
- Please do not throw the batteries into the regular garbage.
- Please also do not throw them into fire or any heat source.

Technical problems

- In case any foreign material or liquid gets into the product, please immediately remove the battery. Before you use it again, ask your authorised dealer to check the product carefully.
- Please do not hesitate to contact our service center.

Packaging material

- Please don't keep any packaging material within reach of small children. It can become a dangerous toy.

Maintenance

- Please remove the battery in case you don't use the product for a longer period of time. Leaking batteries can damage the product. Store

Features

the product at a clean and dry place.

- For cleaning use dry and soft cloth.

Features

- 38 CTCSS Codes
- key lock
- Up to 3-5 km Range, depending on the environment
- Auto Squelch
- Auto Monitor
- Auto Power Save Circuit
- VOX (Baby Room Monitor) / Handsfree Use
- Channel Scan
- Channel / CTCSS Tone Memory
- 5 Selectable Call Tone Melodies
- Out of range function
- LCD Last Used Channel Memory
- Back Lighted LCD Display
- Battery Status / Charge Indicator
- External Earset-Microphone Jack
- NiMH Batteries (600 mAh) Included

Delivery content

2 x Young500 (incl. NiMH rechargeable battery), 2 x AC Adaptor, 2 x Desktop charger, user manual

View of the appliance

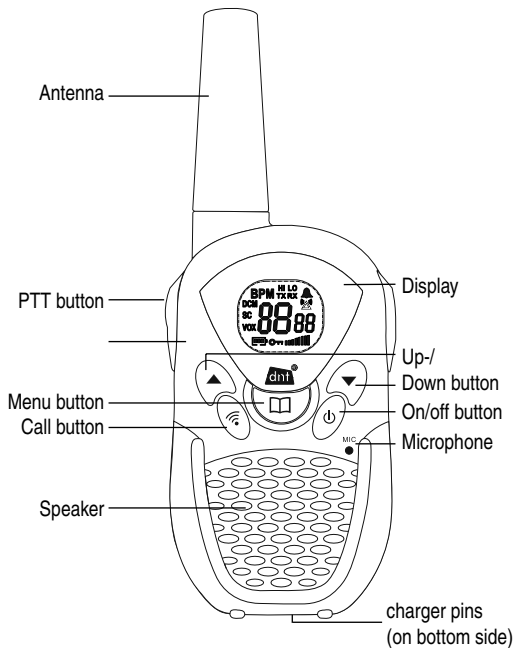

Product information

View of the appliance-Display

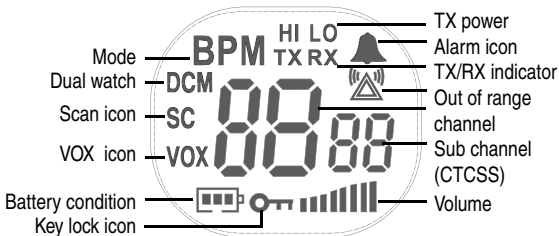

- TX:** This icon appears, if transmitting is in process
- RX:** This icon appears, when the radio receives a signal on the current channel.
- P:** **PMR** mode is selected.
- M:** **Mama** mode is selected.
- B:** **Baby** Mode is selected.

Remove/Install the belt clip

- Pull the belt clip latch away from the unit and push up on the belt clip to remove it.
- Install the belt clip vice versa. During installation a click indicates that the belt clip is locked.

Replace the batteries

The Young500 has rechargeable NiMH batteries. If it is necessary to replace the batteries, proceed as follows:

- Turn the unit off.
- Remove the belt clip and open the battery door.
- Insert the batteries under consideration of the polarity and close the battery door.



Wrong polarity of batteries can damage the two way radio.



In case you do not know clearly how to proceed, please ask your authorised dealer.



If the unit is not used for a long period of time e.g several weeks, please remove the batteries. Otherwise it will erode and damage the batteries.

Recharge the batteries



Don't charge alkaline batteries.

When LCD display battery level is low, the battery needs charging with

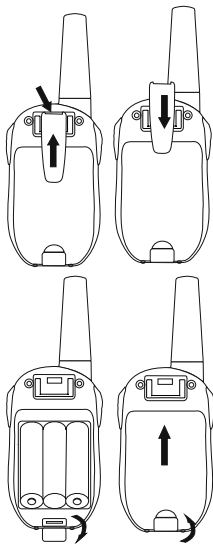

Getting started

the enclosed desktop charger. Charging takes about 10-12 hours.

- Plug the adaptor into the desk top charger.
- Place the radio into the charger.
- During charging, the LED of the charger is on, the radio remains on.
- Take the radio out if charging is finished.
- During charging the unit can be used.

Check battery condition

If the display shows only 1 bar in the battery icon, the battery has to be recharged.

External earset (not in the delivery content)

Earsets can be connected to the radio on to **Headset** jack on the top of the radio.



To avoid damage to the radio use only original dnt accessories.



Turn off the radio before connecting external accessories. Adjust the volume to a low level to avoid injuries by hearing a loud signal.

Turn the radio on

To switch the radio on, press the **On/Off** button for 3 seconds until the display shows *ON* and all icons and a tone is heard. After half a second the display changes to normal mode. At PMR mode the display shows the channel, CTCSS, volume level and battery icon.

Turn the radio off

To switch the radio off, press the **On/Off** button for 3 seconds, until the display shows *OFF* and then turns off.

General

The Young500 has 3 modes:

1. PMR mode(P), 2. Mama mode(M), 3. Baby mode(B)



Not all menu items are available in each mode. For example Dual watch is not available in B mode.

To switch between the modes press 1x the menu button and then the up-/down button to select the desired mode.

PMR mode:

- Channel and CTCSS unchanged, or Channel1, CTCSS0
- VOX **off**
- Power **Hi**
- Roger beep **on**
- Call tone **1**
- Key lock **off**
- Out of range function **off**
- Out of range Alarm **off**

M mode:

- Speaker **on**
- VOX **off**
- Out of range function **on**
- Out of range Alarm **on**

B mode:

- Speaker **off**
- VOX **on**, VOX level **3**
- Out of range function **on**
- Out of range Alarm **off**



All settings made in the menu are stored and the radio returns to standard mode if no button is pressed within 3 seconds.

General operation



Don't touch the antenna during transmission, to avoid malfunction of the radio.

Transmitting

To transmit, press and hold the **PTT** (PUSH-TO-TALK) button and speak with a normal voice from a distance of 5-8 cm away from the microphone. The **TX** icon is on while transmitting. Release the **PTT** button at the end of transmission.

Channel selection

The Young500 offers 8 channels in the PMR band.

To change the channel proceed as follows:

- Press the **Menu** button 2x, the **channel no.** flashes on the display.
- Use the **Up-/Down** button to select the channel.
- Press the **PTT** button to confirm or wait 3 seconds, the changes are stored automatically.

CTCSS code

The Young500 has altogether 38 sub-channels which work in the CTCSS standard. A private sub-audible tone may be programmed and associated with every channel, to protect the radio from unwanted calls or interference from other operators on the same channel. Squelch will open and incoming messages will be received only from radios using the same CTCSS tone on that channel.

To change the CTCSS code proceed as follows:

- Press the **Menu** button twice , CTCSS code display flashes.
- Press **Up-/Down** button to select your desired the CTCSS code (1~38, " 0 " is off)
- Press the **PTT** button to confirm.

VOX / HANDS-FREE OPERATION

VOX allows to switch automatically between transmitting and receiving by voice operation. The radio has a built-in Voice Activated Circuit(VOX)function. You can connect the radio with the earphone for hands-free talking and listening without pressing **PTT** button.

To enable VOX mode proceed as follows:

- Press **Menu** button 5x until LCD displays VOX icon and VOX sensitivity digit display is flashing.
- Press **Up-/Down** button to select 1, 2, 3 for low, medium & high sensitivity. (0 is off)
- After turn on VOX, you need to connect the earphone to use the hands-free function. See below steps.

To turn off the VOX mode proceed as follows:

- Press **Menü / Lock** button three times until LCD displays VOX icon and VOX sensitivity digit display flashes.
- Press **Up-/Down** button to select 0 to switch the VOX to off.
- Press the **PTT** button to confirm or wait about 3 seconds, the changes are stored automatically.

Transmitting VOX/HANDS-FREE (headset not in the delivery content)

- Press **Power On/Off** button to turn off the radio.
- Plug the earphone into the earphone jack
- Press **Power On/Off** button to turn on the radio, LCD display VOX icon.
- Set the earphone microphone close to your mouth (1~3 cm) and speak into the microphone, the radio transmits automatically.
- Stop speaking, the radio stops transmitting and goes into receiving status.

General operation

- Adjust the volume to comfortable level if necessary.



You must turn off the unit before plug the earphone in otherwise the unit will keep on transmitting.

Call-Ring tone

You can use call tones to get the attention of other people with radios on the same channel and CTCSS tone. You can also use call tones as the signal of the start or end of a transmission.

Press **CALL** button, the LCD display **TX** icon and your call tone will be transmitted to nearby receivers set at the same channel. The call tones have 5 kinds of sound for personal selection.

Select call tones

- Press **Menu** button 6x LCD display **CL** icon and call tone number flashes.
- Press **Up-/Down** button to select your desired call tone
- Press the **PTT** button to confirm.

Rogerbeep

The rogerbeep is a tone which is automatically transmitted whenever the **PTT** button is released. This lets the other person know that you have finished talking and you are now in receiving mode.

- Press **Menu** button 7x LCD display **F D** icon and **ON** or **OFF**.
- Press **Up-/Down** button to select rogerbeep, the display shows **ON**, or deselect the roger beep, the display shows **OF**.
- Press the **PTT** button to confirm.

Key tone

This feature allows the handset to sound a confirmation tone whenever keys are pressed.

- Press **Menu** button 8x, LCD display **L D** icon and **ON** or **OFF**.

- Press **Up-/Down** button to select the key tone, the display shows **DT**, or deselect the key tone, the display shows **DF**.
- Press the **PTT** button to confirm.

Receiving

If the radio is turned on, it is automatically set into receiving mode.



To communicate with other radios all radios must have the same channel and sub-channel.

Volume control

The volume can be adjusted in 7 steps.

To change the volume proceed as follows:

- Press the **Up-/Down** button to change the volume.
- The display shows the current volume level.

Monitor function

With the monitor function you can switch off the automatic squelch to listen to the weakest signals, which are cut from the automatic squelch. To activate the monitor press **Menu** button and the **Down** button at the same time. A noise of weak signals is heard. To switch off the monitor function press **Menu** button and **Down** button once again.

Channel scan

Busy channels can be automatically scanned.

To start the scan function proceed as follows:

- Press the **Menu** button and **Down** button at the same time. The channel scanning starts immediately.
- Press the **PTT** button again to stop scanning.
- When the radio detects channel activity, it stops scanning and stays at that channel. Scanning is continued if there is no activity.

General operation

- Press the **UP** button to scan the channels 1-8.
- Press the **DOWN** button to scan the sub-channels.
- When the radio detects channel activity, it stops scanning and stays at that channel. If you press the **PTT** button you can talk on this channel but if the talking stops for more than 4 seconds, the scanning starts again.

Key lock

This function allows to lock the buttonpad, to avoid accidental unwanted commands. To enable / disable the button lock function proceed as follows:

- Press the **Menu** button for approx. 3 second until the key lock icon appears/disappears on the display.



If the button lock function is activated, only the *PTT* and *Call* button can be used. To disable the function proceed in the same way.

Dual Watch(PMR mode only)

The dual watch allows listening to a second channel

- Set main channel first (example channel 2)
- Press **Menu** button 9 times, LCD display shows the **DCM** icon and the channel number display flashes.
- Press **Up-/Down** button to select your desired watch channel (example channel 6) .
- Press the **PTT button** to confirm, the unit will watch channel 2 and 6 by shift. LCD flashes between channel 2 and 6.
- To turn the dual watch off press **Menu** button 9 times. LCD display shows the **DCM** icon and the channel number display flashes.
- Press **Up-/Down** button to select channel number to **0F** to turn off this function.

Power High/Low

To save battery power the unit can be setup to low power if you want to communicate in a short distance.

- Press **Menu** button 4x, LCD display shows the current power **HI** or **LO** icon
- Press **Up-/Down** button to select the desired power.
- Press the **PTT** button to confirm.

Out of range function

This function makes sure that the mama device is within the operating distance of the baby device. If the mama device is longer than 30 seconds beyond reach of the baby device, until  flashes in the display and an acoustical alarm is aroused, provided that this is programmed.

To switch on the function, proceed as follows:

- M mode and B mode: Press 9x the menu button until  flashes in the display
- Switch on the function with **Up-/Down** button.



Out-of-Range-Funktion steht auch im normalen P-Mode zur Verfügung.

- P mode: Press 10x the **Menu** button until  flashes in the display .
- Switch on the function with **Up-/Down** button.
- Press **Menu** button once again until **BP** or **PM** flashes in the display.
- Select now **BP** in one device and **PM** in the other device.

Out of range alarm (only available if **Out of range function** is on)

If the **Out of range function** is set to On an acoustic alarm is aroused, if mama and baby device are not within operating distance.

- P mode: Press 11x the menu button until  flashes in the display .

General operation

- M mode and B mode: Press 10x the menu button until  flashes in the display
- Switch on the function with **Up-/Down** button.

Indications for the application

1 . **Babyphone**

One device must be set to M mode(mama mode) the other one to B mode(baby mode). The baby device should be placed nearby the baby, the other can be used mobile. The equipment has an **Out of range function** which causes a signal as soon as the equipment is not within the operation distance any more. The range is dependent on the buildings and the location where the baby device is operated. It depends on the Output power **HI** (high) or **LO** (low) and the positioning lying or standing.

The equipment has a built-in VOX which activates the device automatically if you speak or noises sound (e.g. baby screaming). The VOX is activated, a certain distance between the built-in microphone and the acoustic source may be not exceeded. You should test the placing of the "baby device" in sufficient measure carefully.

2. **General**

The units are PMR Two way radios which emit a radio signal. This radio signal can be received by everybody which has a similar device or a similar two way radio. Also so-called "radio scanner" can receive and represent such signals without reservation. You should turn off the baby device adversably, if it is not needed, otherwise it can lead to the involuntary conversation of your neighbourhood.

Frequency range	446.00625 - 446.09375 MHz
Channels	8 PMR Kanäle (12.5 KHz channel space)
Modulation	FM (F3E)
Frequency Control	PLL
Power Supply	4.5V (3 x AAA 1.5V alkaline cells) 3.6V (3 x AAA 1.2V NiMH rechargeable batteries)
Temperature Range	-20/+55°C
Antenna	Integrated
Jacks	External Earset-Microphone, charging jack
Dimension	46 x 31 x 120 mm (L x B x H) incl. Antenna
Weight	66 g

Transmitter:

RF Output Power 500 mW / 50 mW e.r.p.

Spurious

& Harmonics entsprechend ETS 300 296 & EN 300 220-1

CTCSS Table

Nr No	Freq. (Hz)	Nr No	Freq. (Hz)	Nr No	Freq. (Hz)	Nr No	Freq. (Hz)
1	67	11	97,4	21	136,5	31	192,8
2	71,9	12	100,0	22	141,3	32	203,5
3	74,4	13	103,5	23	146,2	33	210,7
4	77,0	14	107,2	24	151,4	34	218,1
5	79,7	15	110,9	25	156,7	35	225,7
6	82,5	16	114,8	26	162,2	36	233,6
7	85,4	17	118,8	27	167,9	37	241,8
8	88,5	18	123,0	28	173,8	38	250,3
9	91,5	19	127,3	29	179,9		
10	94,8	20	131,8	30	186,2		

Hiermit erklärt dnt GmbH, dass sich das Gerät YoungStar in Übereinstimmung mit den grundlegenden Anforderungen und den übrigen einschlägigen Bestimmungen der Richtlinie 1999/5/EG (R&TTE) befindet. Die Konformitätserklärung können Sie von der nachfolgenden Seite als PDF-Datei herunterladen:

<http://www.dnt.de/konformitaet>

Hereby, dnt GmbH, declares that this YoungStar is in compliance with the essential requirements and other relevant provisions of Directive 1999/5/EC (R&TTE). The declaration of conformity for this product can be downloaded from:

<http://www.dnt.de/conformity>



Umweltgerechte Entsorgung

Dieses Gerät ist entsprechend der europäischen Richtlinie 2002/96/EG über Elektro- und Elektronik- Altgeräte gekennzeichnet. Nutzen Sie die von Ihrer Kommune eingerichtete Sammelstelle zur Rückgabe und Verwertung elektrischer und elektronischer Altgeräte.

Disposal of old electrical & electronic equipment

This symbol on the product indicates that this product shall not be treated as household waste. Instead it shall be handed over to the applicable collection point for recycling of electrical and electronic equipment. For more detailed information about recycling of this product, please contact your local city office or your household waste disposal service.



Garantiebedingungen

1. Es gelten grundsätzlich die gesetzlichen Garantiebestimmungen. Die Garantiezeit beginnt mit der Übergabe des Gerätes. Im Garantiefall ist das Gerät mit dem Kaufbeleg (Kassenzettel, Rechnung o.ä.), dem korrekt ausgefüllten Gerätepass und einer genauen Fehlerbeschreibung einzureichen. Ohne diese Belege sind wir nicht zur Garantieleistung verpflichtet.
2. Während der Garantiezeit beheben wir kostenlos alle Mängel, soweit sie auf Material oder Fabrikationsfehler zurückzuführen sind. Es bleibt dem Hersteller überlassen, defekte Teile / Geräte auszutauschen oder durch andere zu ersetzen. Weitergehende Ansprüche, gleich welcher Art, sind ausgeschlossen. Ausgetauschte Teile gehen in unser Eigentum über. Haftung für Folgeschäden übernehmen wir nicht.
3. Eingriffe am Gerät durch nicht von uns autorisierte Firmen / Personen führen automatisch zum Erlöschen des Garantieanspruches.
4. Vom Garantieanspruch ausgenommen sind alle Schäden, die durch unsachgemäße Behandlung, Nichtbeachtung der Bedienungsanleitung, ausgelaufene Akkus/Batterien und betriebsbedingte Abnutzung entstehen.
5. Durch Reparatur oder Teileersatz wird die ursprüngliche Garantiezeit nicht verlängert.
6. Diese Garantiebedingungen gelten in der Bundesrepublik Deutschland.

Warranty regulations

1. In general the European warranty regulations are valid. Warranty starts with receipt of unit. In a warranty case, please submit the unit together with invoice, unit pass and error description. Without these documentary evidence we are not obliged to a warranty performance.
2. During warranty period we repair all constructional or material defects which are caused by a manufacturing fault. It is in the decision of the manufacturer to change or replace defective parts/units. Further claims are excluded. Changed parts will automatically go over into our property. We will not be held responsible for future damages.
3. Manipulation on the unit through non-authorized companies/persons automatically leads to an end of warranty period.
4. Excluded of warranty claims are damages due to improper treatment, not following the manual, oxidation of batteries, permanent usage.
5. The initial warranty period is not extended because of repair or replacement of parts.
6. These warranty regulations are valid in the Federal Republic of Germany.

Application de la garantie

1. L'application de la garantie est soumise aux dispositions légales. La période de garantie débute à la remise de l'appareil. En cas d'application de la garantie, nous demandons que soit restitué l'appareil accompagné de son justificatif d'achat (ticket de caisse, facture ou autres), la carte de l'appareil dûment renseignée et une description précise du défaut. Sans ces éléments, nous ne sommes pas tenus d'assurer les prestations de garantie.
2. Pendant la période de garantie, nous réparons gratuitement tous les défauts, dans la mesure où il s'agit de défauts matériels ou de fabrication. Le fabricant est libre de réparer les pièces / appareils défectueux ou de les remplacer. Aucune autre requête, de quelque nature que ce soit, ne sera prise en compte. Les pièces remplacées sont notre propriété. Nous déclinons toute responsabilité pour les éventuels dommages consécutifs.
3. Toute intervention sur l'appareil, effectuée par des sociétés / ou des personnes non autorisées par nos soins, entraîne automatiquement l'annulation de la garantie.
4. Sont exclus de la garantie, tous les dommages résultant d'une utilisation non conforme, du non respect de la notice d'utilisation, de l'épuisement des piles/ou du déchargement des accus et de l'usure normale liée à l'utilisation.
5. La réparation ou le remplacement des pièces ne prolonge en aucun cas la période de garantie initiale.
6. Les présentes conditions de garantie s'appliquent à l'Allemagne fédérale.

Condizioni di garanzia

1. Fondamentalmente valgono le norme di garanzia legali. Il periodo di garanzia inizia dalla consegna dell'apparecchio. Nel caso in cui si debba ricorrere alla garanzia, bisogna consegnare l'apparecchio munito di ricevuta d'acquisto (scontrino fiscale, fattura o altro), di certificato di garanzia compilato correttamente e di una precisa descrizione del difetto. Senza questa documentazione non siamo tenuti ad assicurare le prestazioni previste dalla garanzia.
2. Nel periodo di garanzia ripariamo gratuitamente tutti i difetti riconducibili al materiale o ai difetti di fabbricazione. È a discrezione della casa produttrice riparare pezzi/apparecchi difettosi o sostituirli. Ulteriori diritti – indipendentemente dal genere – sono esclusi. I pezzi sostituiti rimangono di nostra proprietà. Decliniamo ogni responsabilità per eventuali danni successivi.
3. Interventi sull'apparecchio da parte di aziende / persone da noi non autorizzate comportano automaticamente la perdita dei diritti di garanzia.
4. Esclusi dal diritto di garanzia sono tutti i danni derivanti da un uso non appropriato, dall'inosservanza delle istruzioni d'uso, da pile e batterie esaurite e dalla normale usura.
5. La riparazione o la sostituzione di pezzi non implica la proroga del periodo di garanzia originale.
6. Le presenti condizioni di garanzia valgono nella Repubblica Federale Tedesca.



Young500

Garantiekarte ● Warranty card

Drahtlose Nachrichtentechnik
Entwicklungs- und Vertriebs GmbH
Voltastraße 4
D-63128 Dietzenbach

Tel. +49 (0)6074 3714-0
Fax +49 (0)6074 3714-37
Internet <http://www.dnt.de>
Email dnt@dnt.de

Serien Nr.
Serial no.

Kaufdatum:
Date of purchase:

Stempel und Unterschrift des Händlers
Stamp and signature of the dealer

