

Contents

1. Introduction	Page 5
2. Safety Instructions	Page 5
3. Usage in accordance with requirements	Page 6
4. Initiation	Page 6
5. Accumulator Exchange	Page 7
6. Malfunctions	Page 7
7. Technical Data	Page 7

These instructions relate ONLY to this product and contain important information for using the product for the first time. Please keep these instructions for later reference and should always accompany the product in the event of transference to a new user.

1. Introduction

Dear Customer,

Thank you for purchasing the solar light.

With this solar light you purchased a product manufactured according to the current state of technology.

This product fulfils all requirements of the valid European and national regulations. The conformity was proved. The relevant declarations and documentation are deposited with the manufacturer.

To maintain this state and guarantee a safe operation, you as the user will have to follow this operating manual!

2. Safety Instructions



- **In case of damages caused by not following this operating manual, the warranty rights will expire! We exclude liability for any consequential damages!**
- **We exclude liability for property or personal damages caused by inappropriate handling or not following the safety instructions.**
- **In these cases any guarantee rights will expire.**

Due to safety and admission reasons (CE) it is not allowed to arbitrarily reconstruct and/or change the solar light.

Therefore, please keep to the operating manual.

The accident prevention rules of the association of the industrial trade cooperative association for electric plants and working material are to be considered in industrial environments

3. Usage in Accordance with Requirements

The solar light is constructed for the outdoor usage and operation. The integrated accumulators are charged by the solar cell in the upper part of the light. At darkness, the light is automatically switched on and is switched out at sunrise. A very strong light emitting diode (LED) is installed. This LED guarantees a strong luminosity with only slight power consumption.

-- However, please note that the duration of illumination may decrease due to a lack of sunshine as well as in the winter months--

In case of longer periods without sunshine (insolation) the accumulator is charged only insufficiently and is thus not able to guarantee a permanent readiness for operation. However, this does not indicate that the solar light is defect. Please wait for the next sunny days and the light will again be working accordingly.

4. Initiation

1. Please carefully take all parts out of the package.
2. Take the light into your hand as shown in the picture. Slightly press in the stainless steel board on the bottom part (1) and remove the upper part (2).
3. Fix the light to the wall with the enclosed screws through the upper opening.
4. Connect the accumulator plug with the socket (3) of the board.
5. Put in the upper part with the module and catch it with a swing in the bottom.

The solar light is now activated.

Note: The duration of illumination is strongly dependent of the intensity and duration of sunshine during the day. During the winter months the duration of illumination will generally be shorter.

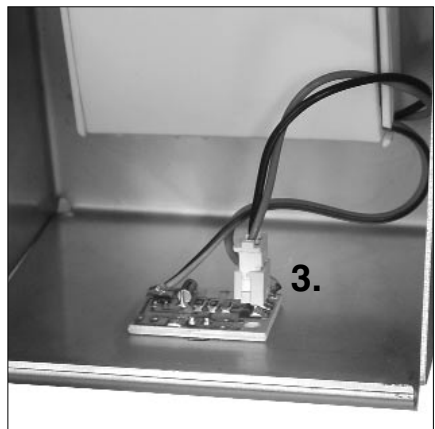
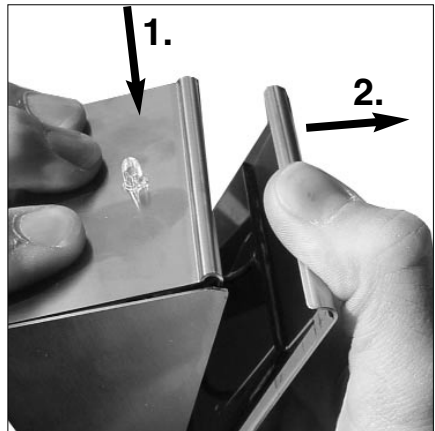

5. Exchange of Accumulators

1. Take off the light's upper part.
2. Open the battery compartment by pressing the lock from the side (1) and swing open the battery compartment (2). Exchange the accumulator pack with a freshly charged and identical one.
3. Re-lock the light in reverse order.

Note: Used batteries or accumulators must be disposed of in a non-polluting way and do not belong into the domestic waste. Your dealer is obliged to take back and recycle old accumulators.



6. Malfunctions

Disorder:

Light is not automatically switched on at darkness.

Remedy:

A further light source (e. g. street lamp) "simulates" daylight and prevents a switching on. Place the light at a darker location.

Light is not automatically switched on at darkness in spite of sunshine or is only switched on for a short time.

Accumulator is weak or defective. Exchange the accumulator pack.

7. Technical Data

Accumulator set: NiMh 3,6 V/600 mAh
 Luminous means: light emitting diode (LED) white
 Solar module: ASI-solar cell

Illuminating period: a maximum of 20 hours in case of full set of accumulators

Battery Recycling

- Batteries must not be disposed of together with the household waste.
 - The consumer is legally obliged to return batteries after usage, e.g. return them to public waste collecting locations or to the dealer selling batteries.
- Batteries containing pollutant substances are marked with the sign "crossed out garbage can" and one of the chemical symbols Cd (= battery contains Cadmium), Hg (= battery contains mercury), Pb (= battery contains lead).

