

Crimphousing 2,54 mm

Series **430**

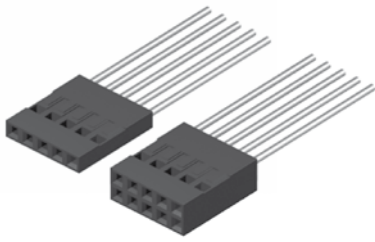

Rated current	3,0 A
Rated voltage	250 VRMS / VDC
Please consider air- and creepage distances	
Withstand voltage	600 VRMS for 1 minute
Material contact	Copper alloy
Material insulator	Thermoplast UL94V-0
Operating temperature	-25°C to +105°C

pitch	2,54
mating pin size	□ 0,64
max. pincount	024

All dimensions in mm.

Variation

Contact

Series **607**

AWG 22 - 26

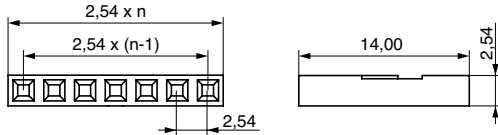

1

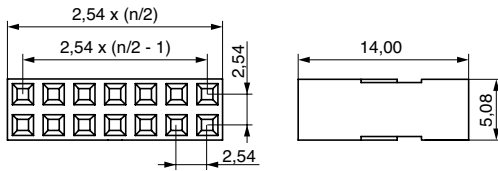
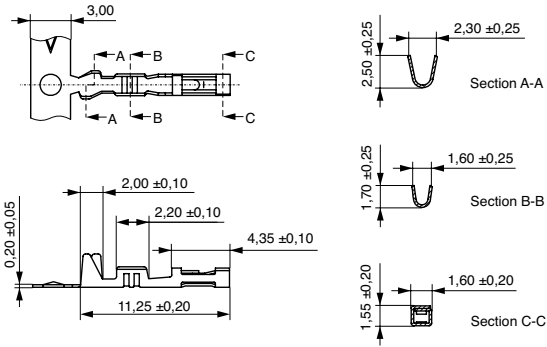

2

Plating: T = Sn
Packaging: L = Bulk, R = Reel

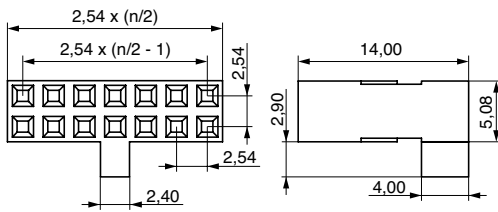

3

607-1-TX-X

Crimp Tool 454

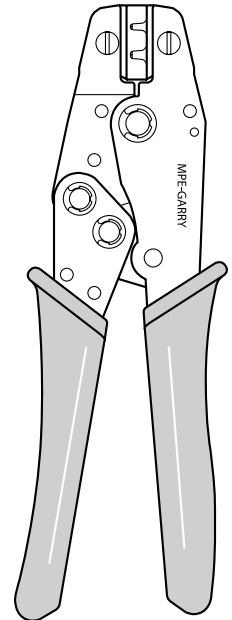

454-1-04

* No. of contacts:
Variation 1 = 002 - 012
Variation 2 = 004 - 024
Variation 3 = 004 - 024

Variation (1,2,3)

No. of contacts *
(002,... - 024)



www.mpe-connector.de

Order code: **430-1-002-X-KS0**

Mating series	087	090	088	334	368	093
see page	3-37	3-39	3-41	3-42	3-43	3-47

MPE-Garry GmbH • Schäßlerstraße 13 • 87629 Füssen • Germany • Phone: +49 (0) 83 62 / 91 56-0 • Fax: +49 (0) 83 62 / 91 56-500 • Email: vk@mpe-connector.de • www.mpe-connector.de

Product group **6**

CS14111_V3